

spaTouch™ 2 & 3

Installation Guide



- spaTouch™ 3
- spaTouch™ 3+

- spaTouch™ 2
- spaTouch™ 2C



VISIT US ONLINE
www.BalboaWaterGroup.com

TOPSIDE PANEL INSTALLATION

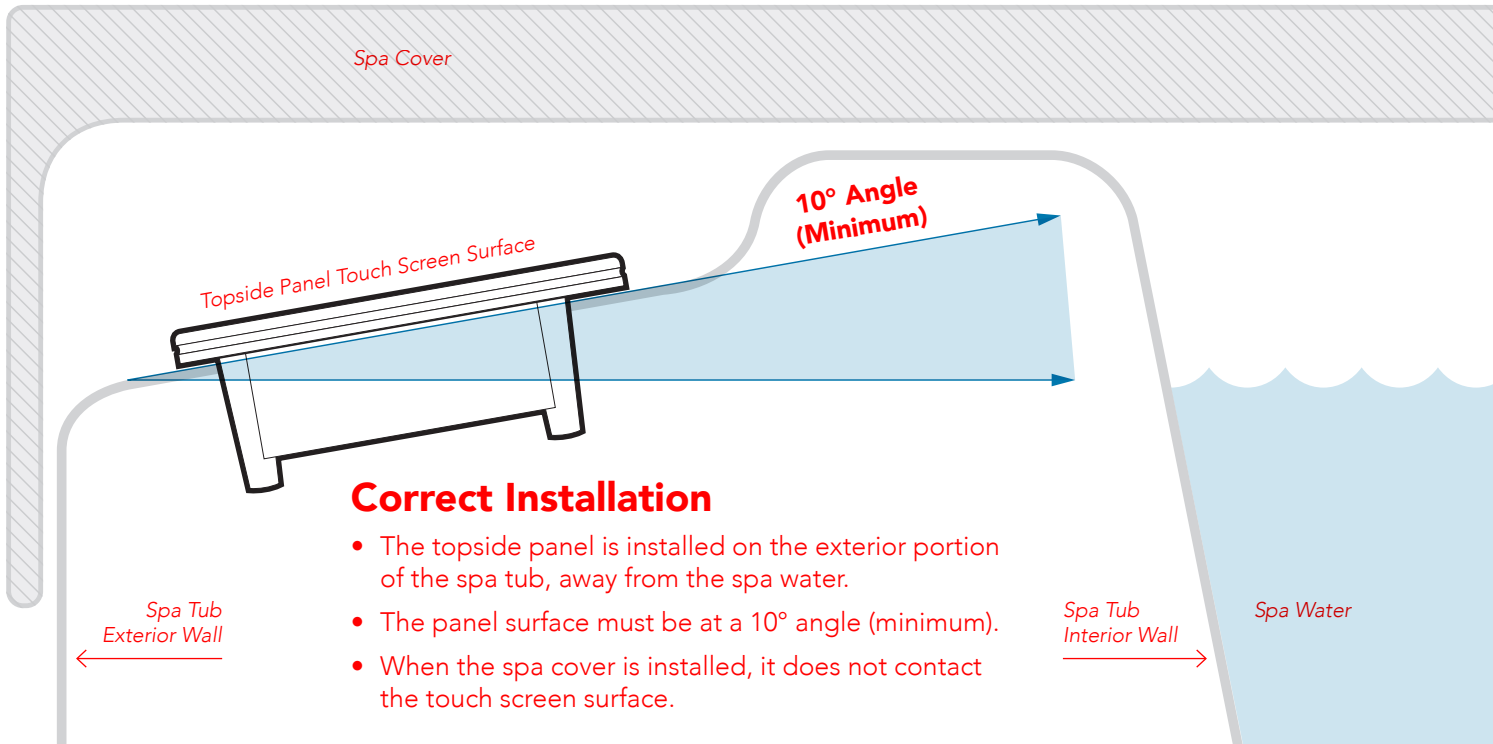

Correct Installation

- The topside panel is installed on the exterior portion of the spa tub, away from the spa water.
- The panel surface must be at a 10° angle (minimum).
- When the spa cover is installed, it does not contact the touch screen surface.

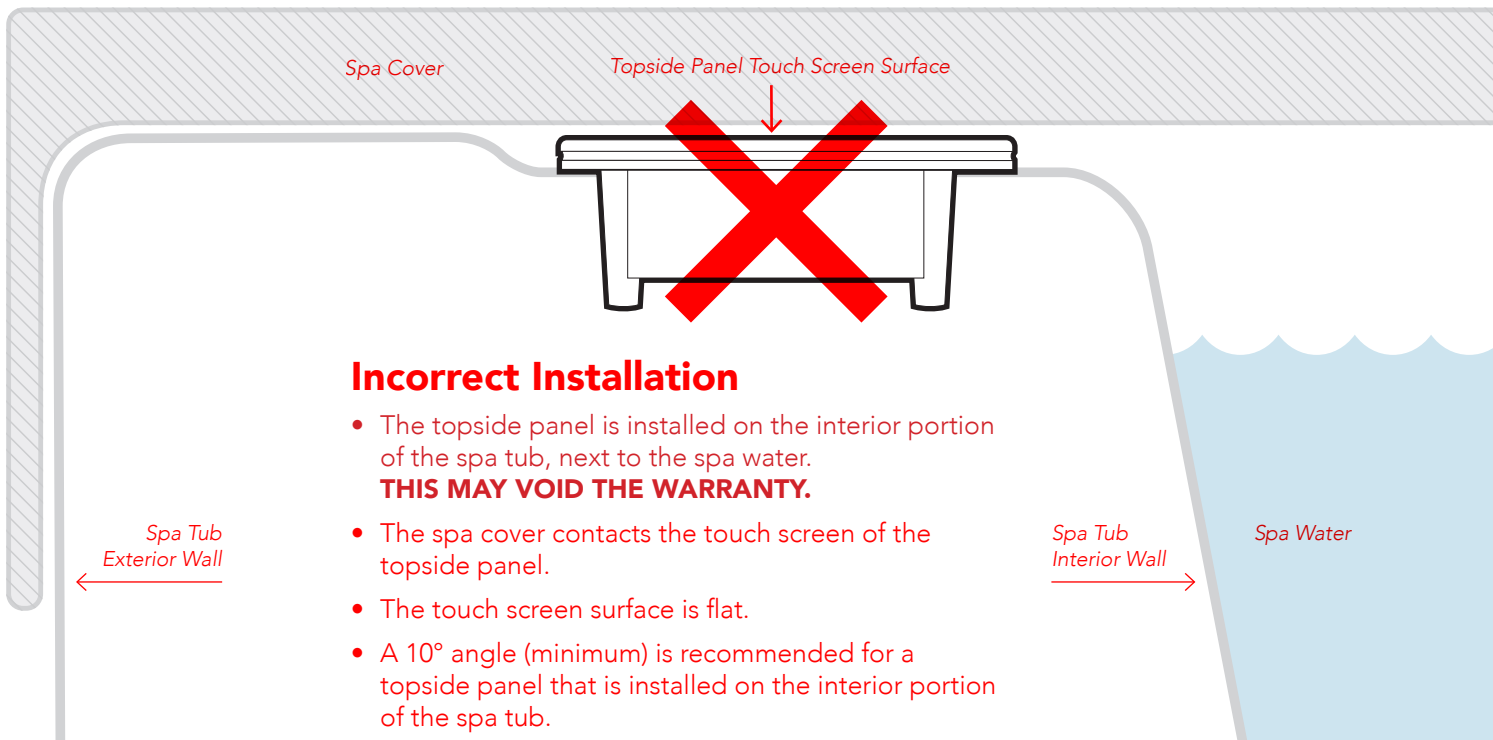

Incorrect Installation

- The topside panel is installed on the interior portion of the spa tub, next to the spa water.
THIS MAY VOID THE WARRANTY.
- The spa cover contacts the touch screen of the topside panel.
- The touch screen surface is flat.
- A 10° angle (minimum) is recommended for a topside panel that is installed on the interior portion of the spa tub.



spaT uch™ 2 & 3

 Email

info@balboawater.com

 Phone

P : + 714.384.0384
Customer Service is available:

M - TH 7:30AM to 7:00PM

F - 7:30AM to 5:00PM PT

 Corporate Office

Balboa Water Group
3030 Airway Avenue
Costa Mesa, CA 92626



MEXICO OPERATIONS

Balboa Water Group
Aguila Azteca 6011
Baja Maq. El Aquila
Mexico 22221

EUROPEAN OPERATIONS

Balboa Water Group
Hydroair International
ApS Roustvej 50 DK-6800
Varde